



## Building Your Stalls Using Horse Stall Kits

### Painted Steel, Galvanized and Mesh Stall Kits

Determining what you need to construct your stalls can be a bit overwhelming at first. The how to build horse stalls guide shown below will hopefully make this task a bit easier.



Horse Stalls Kits get their strength from support posts set into the surface of your barn floor. Normally, we suggest the depth of the support posts to be no less than 30" deep. Support posts should be at least 4" x 4" or larger. The support posts must be set on BOTH sides of the door opening as shown on the image below:

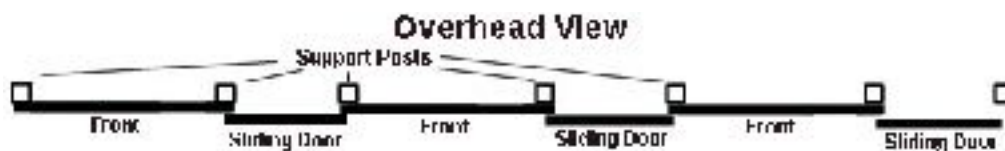

The opening for the stall doorway should measure approximately 4' center to center for the support posts. The additional support post placement will vary depending on if you are building 10' fronts, 12' fronts or larger. In many instances, you might be able to use the existing barn walls as walls for you horse stalls without having to install additional stall walls:

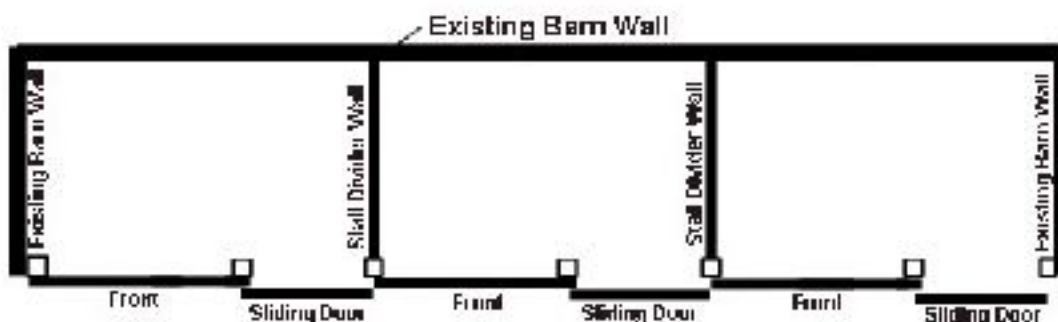

Depending on the construction of your barn, you may find that the existing walls are not suitable for being used as stall walls. In this situation, you will need to install adequate stall walls suitable for horses:

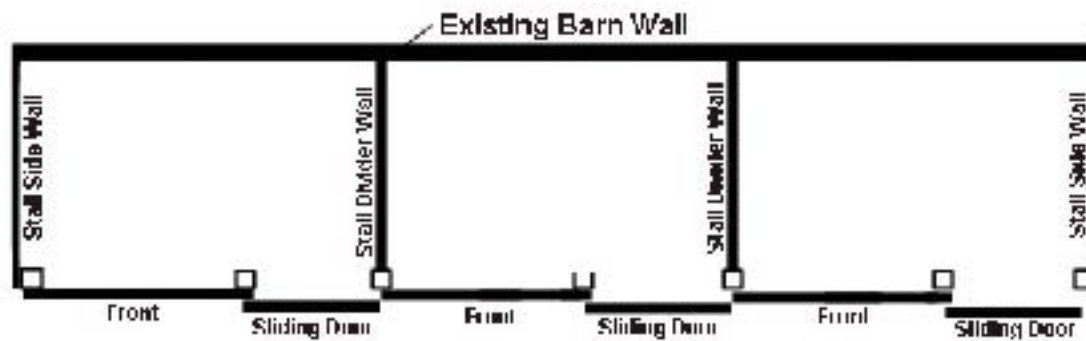

Our stall kits give you excellent flexibility in modifying the stalls to fit your individual needs.

— 240 —

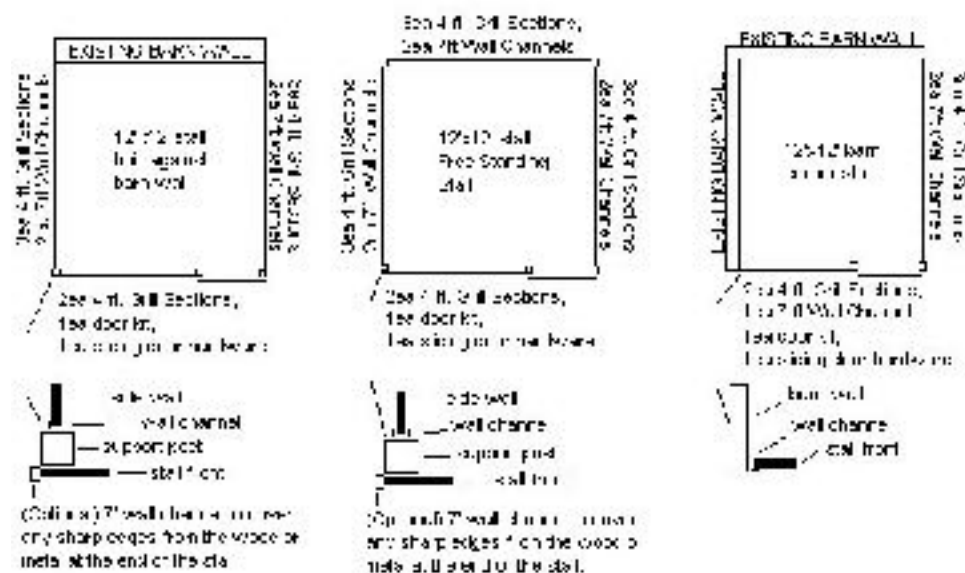

**Typical Stall Exploded View**

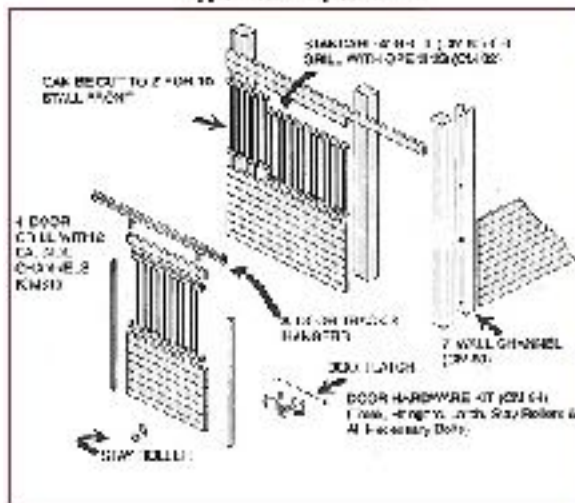

**Note:** All dimensions are designed for a standard 2" lumber (1" thick). NO LUMBER IS INCLUDED.



Black Painted Steel Shell  
with Utility Door

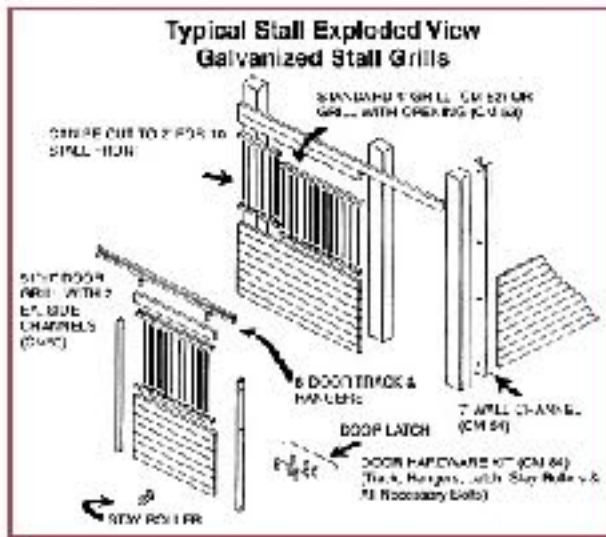

Note: All channels are designed to accept standard 2" x 6" (1 1/2" thick). NO LUMBER IS INCLUDED.



Galvanized Stall with Feed Opening

We suggest the use of tongue and groove 2 x 6 inch lumber for maximum strength and general appearance. Tongue and groove interlocks with each board to prevent gapping when humidity levels change in the barn.

### Lumber Requirements:

Stall Front (Including Door) .....	11 ea. 2" x 6" Tongue and Groove Boards
Grilled Side Wall .....	10 ea. 2" x 6" Tongue and Groove Boards
Solid Side or Back Wall .....	17 ea. 2" x 6" Tongue and Groove Boards